

# 7800 BASIC FOOTREST

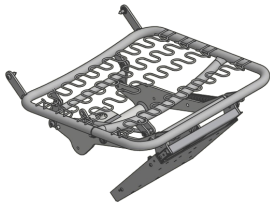

- > All mechanisms are available as a standard option
- > All mechanisms can be customized to accommodate special requirements
- > All mechanisms can be combined with more products for complete solution

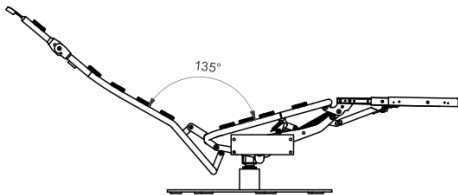
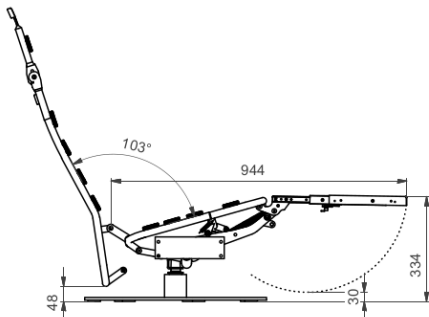
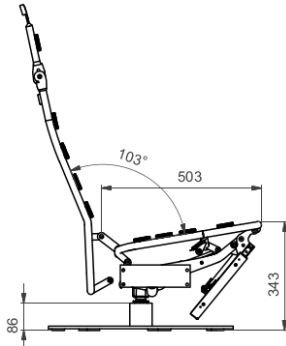

## Functionality and benefits

- > With a slight push to the armrest the footrest elevates and extends
- > Smooth reclining movement
- > Ergonomic and comfortable sitting position
- > Adjustable position of back frame
- > Armrest is optional and can be mounted with fixed bridge or adaptor solution to fit customized design
- > Compatible with different triggers and motor solutions
- > Suitable for chairs with both swivel or 4-legs
- > Prepared for 2- or 3-seat versions
- > Prepared for 1 or 2 motors

## Technical specifications

- > Min. front height 345 mm
- > Standard seat width 500 mm (max 800 mm)
- > Footrest length 438 mm
- > Footrest start position 50°

## COMPATIBLE PRODUCTS

This mechanism can be combined with more products including frames, triggers, adapters, center tubes, bases and swivel parts.

**CLICK** to see more information and product options online

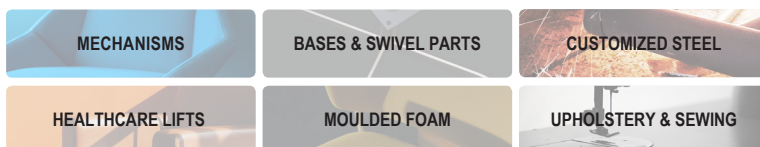

- > Simplify your supply chain
- > Secure strong cooperation
- > Experience hands-on support

